

NovAseptic® Valve Valve Body, Take off Valve

Catalogue Number NU###/480###-211

Valve Body, Take off Valve Configuration

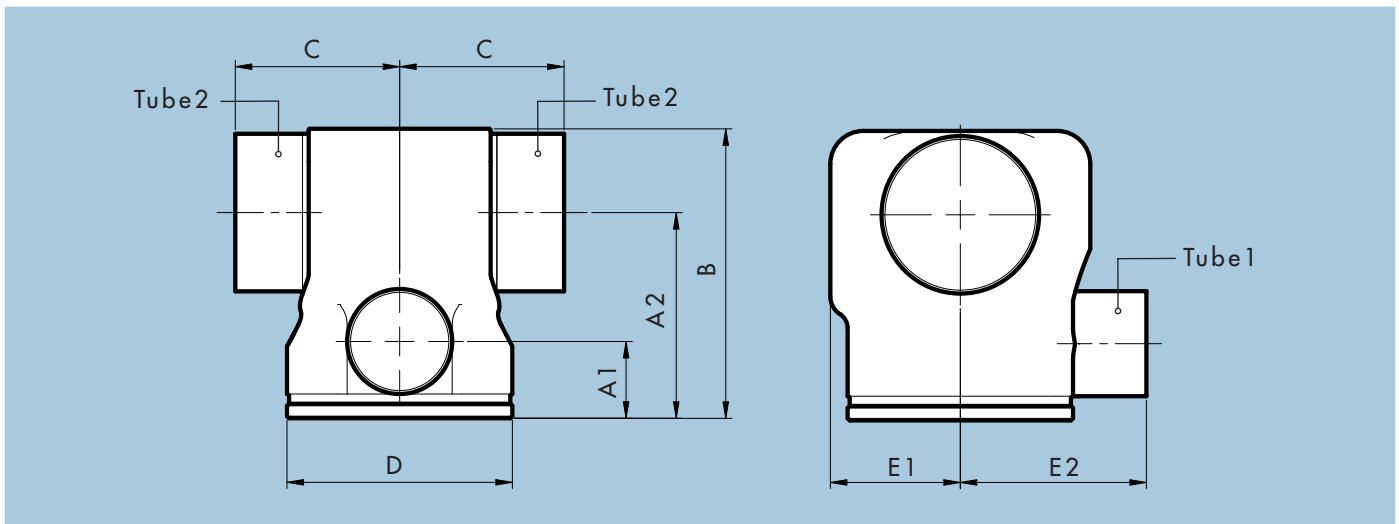

Nominal Dimensions in mm (in.)

A1	A2	B	C	D*	E1	E2	NU###	Tube1	/480###	Tube2
12.4 (0.488)	30.8 (1.213)	49.0 (1.929)	45.0 (1.772)	TR40x2	23.9 (0.941)	49.0 (1.929)	NU050	12.7x1.65 (0.5x0.065)	100	25.4x1.65 (1.0x0.065)
12.4 (0.488)	37.1 (1.461)	57.0 (2.244)	45.0 (1.772)	TR40x2	26.5 (1.043)	51.5 (2.028)	NU050	12.7x1.65 (0.5x0.065)	150	38.1x1.65 (1.5x0.065)
12.4 (0.488)	43.5 (1.713)	70.0 (2.756)	45.0 (1.772)	TR40x2	31.5 (1.240)	56.5 (2.224)	NU050	12.7x1.65 (0.5x0.065)	200	50.8x1.65 (2.0x0.065)
18.0 (0.709)	44.4 (1.748)	64.0 (2.520)	52.5 (2.067)	TR55x2	32.0 (1.260)	57.5 (2.264)	NU075	19.1x1.65 (0.75x0.065)	150	38.1x1.65 (1.5x0.065)
18.0 (0.709)	50.8 (2.000)	77.0 (3.031)	52.5 (2.067)	TR55x2	33.3 (1.311)	57.5 (2.264)	NU075	19.1x1.65 (0.75x0.065)	200	50.8x1.65 (2.0x0.065)
24.1 (0.949)	54.2 (2.134)	74.0 (2.913)	62.5 (2.461)	TR75x2	37.5 (1.476)	63.5 (2.500)	NU100	25.4x1.65 (1.0x0.065)	150	38.1x1.65 (1.5x0.065)
24.1 (0.949)	60.5 (2.382)	87.0 (3.425)	62.5 (2.461)	TR75x2	42.4 (1.669)	67.5 (2.657)	NU100	25.4x1.65 (1.0x0.065)	200	50.8x1.65 (2.0x0.065)
24.1 (0.949)	73.2 (2.882)	112.0 (4.409)	62.5 (2.461)	TR75x2	49.0 (1.929)	74.5 (2.933)	NU100	25.4x1.65 (1.0x0.065)	300	76.2x1.65 (3.0x0.065)
30.6 (1.205)	67.4 (2.654)	88.0 (3.465)	67.5 (2.657)	TR85x2	42.5 (1.673)	67.5 (2.657)	NU150	38.1x1.65 (1.5x0.065)	150	38.1x1.65 (1.5x0.065)
30.6 (1.205)	73.8 (2.906)	100.0 (3.937)	67.5 (2.657)	TR85x2	49.3 (1.941)	77.5 (3.051)	NU150	38.1x1.65 (1.5x0.065)	200	50.8x1.65 (2.0x0.065)
30.6 (1.205)	86.5 (3.417)	127.0 (5.000)	67.5 (2.657)	TR85x2	52.5 (2.067)	77.5 (3.051)	NU150	38.1x1.65 (1.5x0.065)	300	76.2x1.65 (3.0x0.065)
37.0 (1.457)	86.8 (3.425)	116.0 (4.567)	79.5 (3.130)	TR109x2	54.5 (2.146)	79.5 (3.130)	NU200	50.8x1.65 (2.0x0.065)	200	50.8x1.65 (2.0x0.065)
37.0 (1.457)	99.5 (3.917)	140.0 (5.512)	79.5 (3.130)	TR109x2	62.9 (2.476)	89.5 (3.524)	NU200	50.8x1.65 (2.0x0.065)	300	76.2x1.65 (3.0x0.065)

* Note: Non-standard thread, special thread to fit NovAseptic Actuators.

Specifications

Net Weight (approximate)

Valve Body	NU050			NU075		NU100			NU150			NU200	
/480	100	150	200	150	200	150	200	300	150	200	300	200	300
Weight kg (lb)	0.4 (0.88)	0.4 (0.88)	0.5 (1.1)	0.7 (1.5)	0.8 (1.8)	1.4 (3.09)	1.6 (3.53)	2.0 (4.41)	1.9 (4.19)	2.4 (5.29)	1.8 (3.97)	4.0 (8.82)	5.1 (11.2)

Material

	Bar Stainless Steel in Compliance with		Tubing Stainless Steel in Compliance with	
Material Code	316L	EN 1.4404	TP316L	EN 1.4404
Technical Requirements	ASME® SA-479	EN 10272	ASTM® A269/270	EN 10217-7/ EN 10216-5

Surface Roughness: Internal surface (manually polished) $Ra \leq 0.5\mu\text{m}$ (20 μin)
External surface $Ra \leq 1.6\mu\text{m}$ (63 μin)

Design Temperature, Valve Body: -80 to 200 °C (-112 to 392 °F)

Design Pressure, Valve Body: -1 to 10 bar(g) (-14.5 to 145 psi(g))

Note! The applied diaphragm and actuator may have different design temperature and/or pressure limits. The weakest component in the assembled product determines the maximum design temperature and pressure limits.

Labeling: Each Valve Body is individually labeled for full traceability and heat No. according to Millipore QA routines.

Packaging: All open ends on the Valve Body are protected with plastic covers on delivery and packaged in a closed box.

Quality Control: Millipore Quality Assurance System guarantees the control and traceability at all stages of the manufacturing.

In Compliance With: The NovAseptic Valve is classified in Europe, under SEP (Sound Engineering Practice) for PED Directive 97/23/EC. NovAseptic Valve is in compliance with ASME® BPE standard. The NovAseptic Valve meets the requirements of the 3-A Sanitary Standards, marked on request.

Options: For non-standard NovAseptic Valve Body Options, please contact Millipore for further information.

To Place an Order or Receive Technical Assistance

For additional information call your nearest Millipore office or visit us at www.millipore.com.

In the U.S. and Canada, call toll-free 1-800-MILLIPORE (1-800-645-5476). In the U.S., Canada and Puerto Rico, fax orders to 1-800-MILLIFX (1-800-645-5439).

MILLIPORE

Millipore and NovAseptic are registered trademarks of Millipore Corporation or an affiliated company.

ASME is a registered trademark of the American Society of Mechanical Engineers.

ASTM is a registered trademark of the American Society for Testing and Materials.

Specifications subject to change without notice.

Lit. No. SP1114EN00 Rev. -, 09/2006. Replaces DS-058

© 2006 Millipore Corporation. All rights reserved.